

### Installing instruction

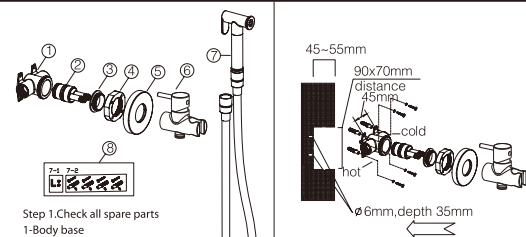

- Step 1. Check all spare parts
- 1- Body base
  - 2- Valve core
  - 3- Connector
  - 4- Nut
  - 5- Cover
  - 6- Body
  - 7- Pipe
  - 8- Spare part bag

- Step 2. Dig hole for body to handle
- 2.1- Hole size 90\*70mm, depth from 45 to 55mm
  - 2.2- Dig two 6mm holes with 45mm distance
  - 2.3- Assemble spare parts as picture shows

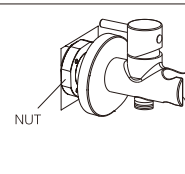

Step 3. Lock the nuts on the body base.



Step 4. Connect inside pipe and test for leak checking

# PRODUCT INFORMATION SUMMARY



Ref.	EAN	Finish
RDM001	8435668003452	Chrome
RDM001/BGM	8435668032155	Black gun metal
RDM001/NG	8435668003469	Matte black
RDM001/ORC	8435668032179	Brushed rose gold
RDM001/OC	8435668028929	Brushed gold
RDM001/NQ	8435668014182	Brushed nickel

CODE	NAME	MATERIAL	REF
1	Body	Brass	
2	O-ring	NBR	
3	Connect	Brass	
4	Hose	Brass	
5	O-ring	NBR	
6	Connect	Brass	
7	Nut	Brass	
8	Cover	Brass	
9	O-ring	NBR	
10	Body	Brass	
11	O-ring	NBR	
12	Connect	Brass	
13	Cartridge	25mm	CRT018*
14	Nut	Brass	
15	Cover	ABS	
16	Handle	Zinc	
17	Screw	SUS 304	
18	Cover	ABS	
19	Spray gun	SUS 304	SMD005*
20	Rubber	NBR	
21	Hose	SUS 304/PVC	FLX008*

\* CONSULTAR PARA ACABADOS DE COLOR

### Usage function instruction

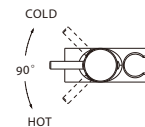
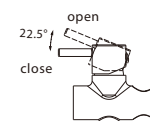

## FLOW RATE

Detalles	
FLOW RATE REF	RDM001
mixer water 0.1Mpa(L/MIN)	3.54
mixer water 0.3Mpa(L/MIN)	6.15
mixer water 0.5Mpa(L/MIN)	8.08
singer cold water 0.1Mpa(L/MIN)	3.4
singer cold water 0.3Mpa(L/MIN)	5.9
singer cold water 0.5Mpa(L/MIN)	7.69

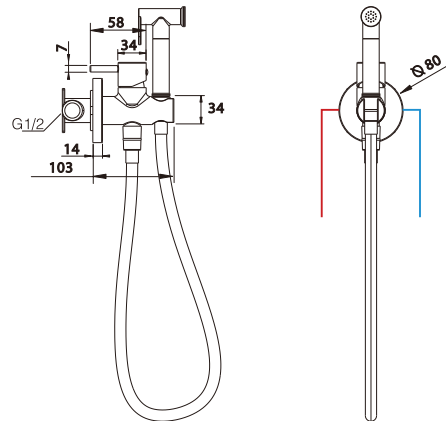
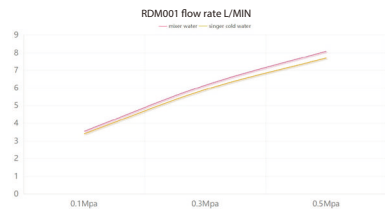

Product sizes (cm)	19.5*13*15
Weight (kg)	1.7
Guarantee	5 years
Max Pressure (bar)	5
Min Pressure (bar)	0.5
Optimum pressure (bar)	1-4 (Recommended 3)
Max. temperature	85°C
Min temperature	65°C

## CERTIFIES

That all our products, provided that they are used in normal conditions or installed in accordance with current standards, are guaranteed against any manufacturing defect for a period of five years, except for products purchased before January 1, 2020, which will have the mandatory coverage of 2 years from the date of invoice.

Requirements and exclusions

Failure to comply with the instructions for assembly, use and maintenance of our products on the packaging and in our catalogue and published on our website: [www.imexproducts.es](http://www.imexproducts.es), releases IMEX PRODUCTS, S.L. from any liability.

In any case, the acceptance of the defect by our technical department is necessary. In addition, transport costs will be charged only in the event that an IMEX PRODUCTS, S.L. technician determines the proper functioning of our products.

IMEX PRODUCTS, S.L. will decide to repair the product or replace it. It will be necessary to present the purchase invoice.

Assembly, maintenance or repairs carried out by non-specialists are excluded from the warranty.

Wearing parts such as hoses, handles, seals, filters, aerators, etc. are not covered by the warranty.

