

POOLIMEX

POOL
Series

POOLIMEX

POOL
Series

POOLIMEX

POOL
Series

POOLIMEX

PRODUCT INFORMATION SUMMARY

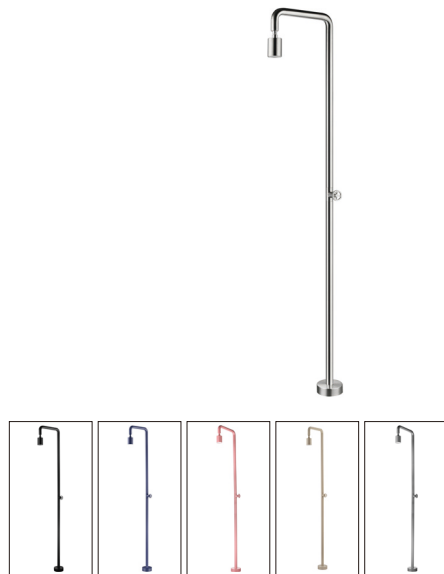

Ref.	EAN	Finish
GPP001/AC	8435668043083	ACERO S.316
GPP001/ANG	8435668058650	NEGRO MATE
GPP001/AAO	8435668058667	AZUL OCEANO
GPP001/ACL	8435668058674	ROSA CORAL
GPP001/AMK	8435668058681	MOKA
GPP001/AGCB	8435668058698	GRIS COBALTO

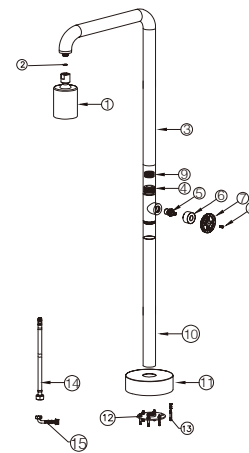

CODE	NAME	MATERIAL	REF
1	Ø80mm G1/2 shower head	SUS316	
2	G1/2 rubber	NBR	
3	upper pipe	SUS316	
4	faucet body	SUS316	
5	MINGRUI HQ2118 cartridge	assembly	Ø23.5MM
6	decorative cup	SUS 316	
7	handle	SUS 316	
8	screw	SUS 304	
9	28*3.5mm rubber	NBR	
10	down pipe	SUS 316	
11	Ø160mm cover plate(42mm hole)	SUS 316	
12	Ø152mm fixed seat(42mm hole)	SUS 316	
13	screw	SUS 304	
14	1.3m*Ø14mm G1/2 inlet pipe	SUS 316	
15	G1/2 elbow connection	SUS 316	

* CONSULTAR PARA ACABADOS DE COLOR

Installing instruction

Step 1. Embed water pipe underground

Step 2. Connectez le tuyau d'entrée

Step 3. Serrer les vis

Step 4. Fermer la plaque de couverture

Step 5. Connect the faucet body with the pipes

Step 6. Connect the shower head

POOL

Series

POOLIMEX

FLOW RATE

Detalles	
FLOW RATE REF	GPP001
Top shower 0.1Mpa(L/MIN)	4.7
Top shower 0.3Mpa(L/MIN)	12.6
Top shower 0.5Mpa(L/MIN)	17.8

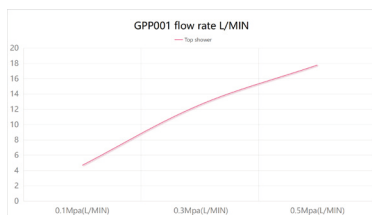

POOL

Series

POOLIMEX

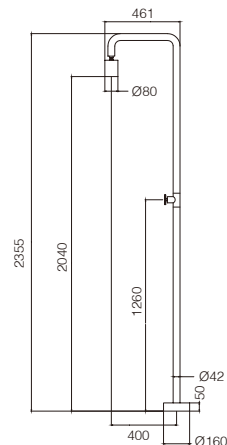

Product sizes (cm)	126.5*53.7*10.7
Weight (kg)	8.3
Guarantee	10 years
Max Preassure (bar)	8
Min Preassure (bar)	1
Optimum preassure (bar)	3-4
Max. temperature	55 °C
Min temperature	0 °C

POOL

Series

POOLIMEX

CERTIFIES

That all our products, provided that they are used in normal conditions or installed in accordance with current standards, are guaranteed against any manufacturing defect for a period of five years, except for products purchased before January 1, 2020, which will have the mandatory coverage of 2 years from the date of invoice.

Requirements and exclusions

Failure to comply with the instructions for assembly, use and maintenance of our products on the packaging and in our catalogue and published on our website: www.imexproducts.es, releases IMEX PRODUCTS, S.L. from any liability.

In any case, the acceptance of the defect by our technical department is necessary. In addition, transport costs will be charged only in the event that on IMEX PRODUCTS, S.L. technician determines the proper functioning of our products.

IMEX PRODUCTS, S.L. will decide to repair the product or replace it. It will be necessary to present the purchase invoice.

Assembly, maintenance or repairs carried out by non-specialists are excluded from the warranty.

Wearing parts such as hoses, handles, seals, filters, aerators, etc. are not covered by the warranty.

