

**PRODUCT
INFORMATION
SUMMARY**

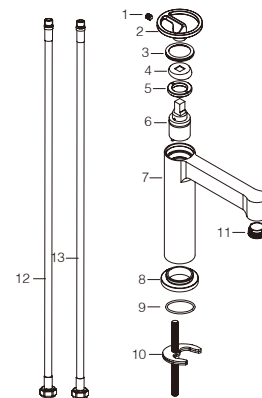

Ref.	EAN	Finish
BDC033-1	8435668010863	Chrome
BDC033-1NG	8435668010870	Matte black
BDC033-1ORC	8435668033756	Brushed rose gold
BDC033-1OC	8435668033749	Brushed gold



CODE	NAME	MATERIAL	REF
1	Screw	SUS 304	
2	Handle	Zinc	
3	Decorative cap	Brass	
4	Semicircular cap	Brass	
5	Nut	Brass	
6	Cartridge	26mm up	CRT006*
7	Body	Brass	
8	Base	Brass	
9	O-ring	NBR	
10	Single hole fixation set	SUS 304	
11	Aerator	18.5mm	SAT-AIRO06*
12/13	Connecting Pipe	TAQ-PEX-DN6-ACB H3/8-M10X1 L12-500-R&B	SAT-HOSES7*

* CONSULTAR PARA ACABADOS DE COLOR

Installing instruction

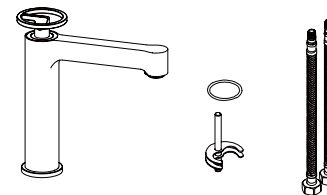

Step 1. Check all spare parts ready

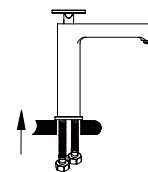

Step 2. Install inlet pipe to faucet body

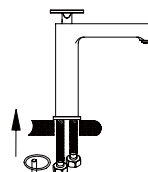

Step 3. Install screw stick to faucet body

FLOW RATE

Detalles	
FLOW RATE REF	BDC033-1
mixer water 0.1Mpa(L/MIN)	7.04
mixer water 0.3Mpa(L/MIN)	11.97
mixer water 0.5Mpa(L/MIN)	15.81
singer cold water 0.1Mpa(L/MIN)	6.26
singer cold water 0.3Mpa(L/MIN)	10.74
singer cold water 0.5Mpa(L/MIN)	13.98

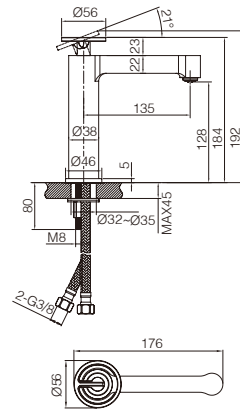
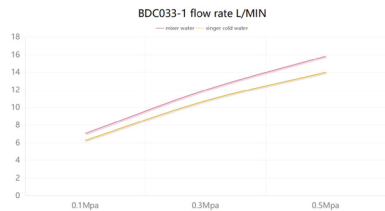

Product sizes (cm)	30*21*5.9
Weight (kg)	1.2
Guarantee	5 years
Max Preassure (bar)	5
Min Preassure (bar)	0.5
Optimum preassure (bar)	1-4 (Recommended 3)
Max. temperature	85°C
Min temperature	65°C

CERTIFIES

That all our products, provided that they are used in normal conditions or installed in accordance with current standards, are guaranteed against any manufacturing defect for a period of five years, except for products purchased before January 1, 2020, which will have the mand atory coverage of 2 years from the date of invoice.

Requirements and exclusions

Failure to comply with the instructions for assembly, use and maintenance of our products on the packaging and in our catalogue and published on our website: www.imexproducts.es, releases IMEX PRODUCTS, S.L. from any liability.

In any case, the acceptance of the defect by our technical department is necessary. In addition, transport costs will be charged only in the event that on IMEX PRODUCTS, S.L. technician determines the proper functioning of our products.

IMEX PRODUCTS, S.L. will decide to repair the product or replace it. It will be necessary to present the purchase invoice.

Assembly, maintenance or repairs carried out by non-specoalists re excluded from the warranty.

Wearing parts such as hoses, handles, seals, filters, aerators, etc. are not covered by the warranty.



**PRODUCT
INFORMATION
SUMMARY**



Ref.	EAN	Finish
BDC033-2	8435668033763	Chrome
BDC033-2NG	8435668033770	Matte black
BDC033-2ORC	8435668033794	Brushed rose gold
BDC033-2OC	8435668033787	Brushed gold

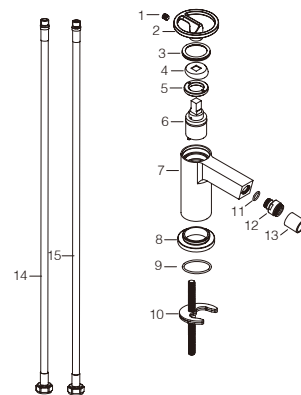

CODE	NAME	MATERIAL	REF
1	Screw	SUS 304	
2	Handle	Zinc	
3	Decorative cap	Brass	
4	Semicircular cap	Brass	
5	Nut	Brass	
6	Cartridge	26mm up	CRT007*
7	Body	Brass	
8	Base	Brass	
9	O-ring	NBR	
10	Single hole fixation set	SUS 304	
11	Spout gasket	NBR	
12	Spout	Brass	
13	Gasket	NBR	SAT-AIR032*
14/15	Connecting Pipe	TAQ-PEX-DN6-ACB H3/8-M10X1 L12-500-R&B	SAT-HOSES7*

* CONSULTAR PARA ACABADOS DE COLOR

Installing instruction

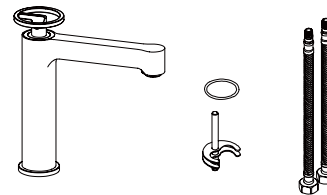

Step 1. Check all spare parts ready

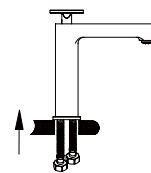

Step 2. Install inlet pipe to faucet body

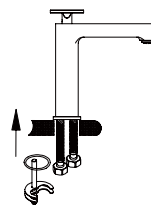

Step 3. Install screw stick to faucet body

FLOW RATE

Detalles	
FLOW RATE REF	BDC033-2
mixer water 0.1Mpa(L/MIN)	6.92
mixer water 0.3Mpa(L/MIN)	11.85
mixer water 0.5Mpa(L/MIN)	15.31
singer cold water 0.1Mpa(L/MIN)	5.77
singer cold water 0.3Mpa(L/MIN)	9.63
singer cold water 0.5Mpa(L/MIN)	12.29

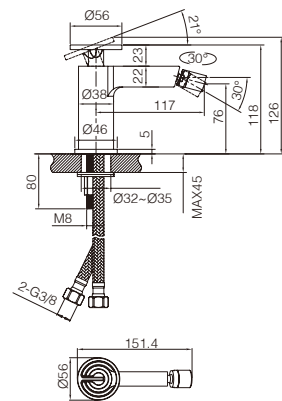
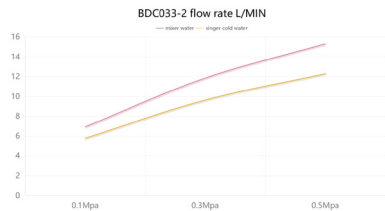

Product sizes (cm)	26.7*18.1*5.9
Weight (kg)	0.98
Guarantee	5 years
Max Preassure (bar)	5
Min Preassure (bar)	0.5
Optimum preassure (bar)	1-4 (Recommended 3)
Max. temperature	85°C
Min temperature	65°C

CERTIFIES

That all our products, provided that they are used in normal conditions or installed in accordance with current standards, are guaranteed against any manufacturing defect for a period of five years, except for products purchased before January 1, 2020, which will have the mand atory coverage of 2 years from the date of invoice.

Requirements and exclusions

Failure to comply with the instructions for assembly, use and maintenance of our products on the packaging and in our catalogue and published on our website: www.imexproducts.es, releases IMEX PRODUCTS, S.L. from any liability.

In any case, the acceptance of the defect by our technical department is necessary. In addition, transport costs will be charged only in the event that on IMEX PRODUCTS, S.L. technician determines the proper functioning of our products.

IMEX PRODUCTS, S.L. will decide to repair the product or replace it. It will be necessary to present the purchase invoice.

Assembly, maintenance or repairs carried out by non-specoalists re excluded from the warranty.

Wearing parts such as hoses, handles, seals, filters, aerators, etc. are not covered by the warranty.



**PRODUCT
INFORMATION
SUMMARY**



Ref.	EAN	Finish
BDC033-3	8435668010894	Chrome
BDC033-3NG	8435668010900	Matte black
BDC033-3ORC	8435668033817	Brushed rose gold
BDC033-3OC	8435668033800	Brushed gold

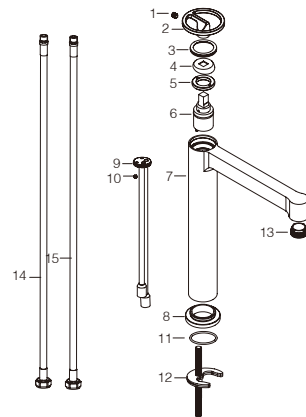

CODE	NAME	MATERIAL	REF
1	Screw	SUS 304	
2	Handle	Zinc	
3	Decorative cap	Brass	
4	Semicircular cap	Brass	
5	Nut	Brass	
6	Cartridge	26mm up	CRT007*
7	Body	Brass	
8	Base	Brass	
9	Base	Brass	
10	Screw	SUS 304	
11	O-ring	NBR	
12	Single hole fixation sets	SUS 304	
13	Aerator	18.5mm	SAT-AIR006*
14/15	Connecting Pipe	TAQ-PEX-DN6-ACB H3/8-M10X1 L12-500-R&B	SAT-HOSES7*

* CONSULTAR PARA ACABADOS DE COLOR

Installing instruction

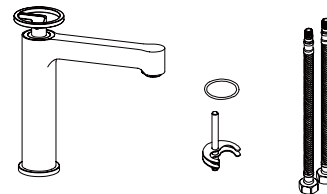

Step 1. Check all spare parts ready

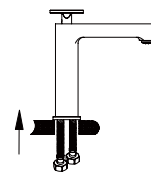

Step 2. Install inlet pipe to faucet body

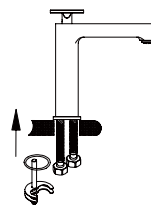

Step 3. Install screw stick to faucet body

FLOW RATE

Detalles	
FLOW RATE REF	BDC033-3
mixer water 0.1Mpa(L/MIN)	6.68
mixer water 0.3Mpa(L/MIN)	11.48
mixer water 0.5Mpa(L/MIN)	14.81
singer cold water 0.1Mpa(L/MIN)	6.65
singer cold water 0.3Mpa(L/MIN)	11.46
singer cold water 0.5Mpa(L/MIN)	14.77

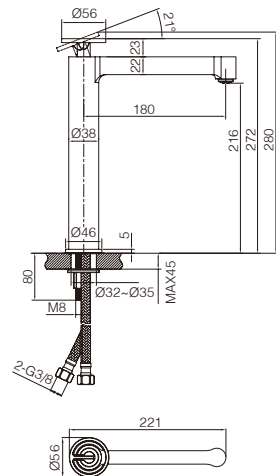
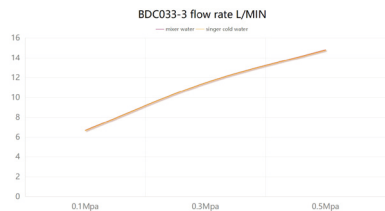

Product sizes (cm)	39*21*5.9
Weight (kg)	1.45
Guarantee	5 years
Max Preassure (bar)	5
Min Preassure (bar)	0.5
Optimum preassure (bar)	1-4 (Recommended 3)
Max. temperature	85°C
Min temperature	65°C

CERTIFIES

That all our products, provided that they are used in normal conditions or installed in accordance with current standards, are guaranteed against any manufacturing defect for a period of five years, except for products purchased before January 1, 2020, which will have the mand atory coverage of 2 years from the date of invoice.

Requirements and exclusions

Failure to comply with the instructions for assembly, use and maintenance of our products on the packaging and in our catalogue and published on our website: www.imexproducts.es, releases IMEX PRODUCTS, S.L. from any liability.

In any case, the acceptance of the defect by our technical department is necessary. In addition, transport costs will be charged only in the event that on IMEX PRODUCTS, S.L. technician determines the proper functioning of our products.

IMEX PRODUCTS, S.L. will decide to repair the product or replace it. It will be necessary to present the purchase invoice.

Assembly, maintenance or repairs carried out by non-specoalists re excluded from the warranty.

Wearing parts such as hoses, handles, seals, filters, aerators, etc. are not covered by the warranty.



**PRODUCT
INFORMATION
SUMMARY**

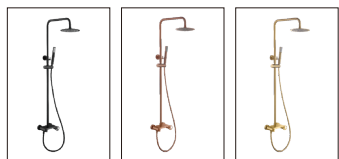

Ref.	EAN	Finish
BDC033	8435668033701	Chrome
BDC033-NG	8435668033718	Matte black
BDC033-ORC	8435668033732	Brushed rose gold
BDC033-OC	8435668033725	Brushed gold

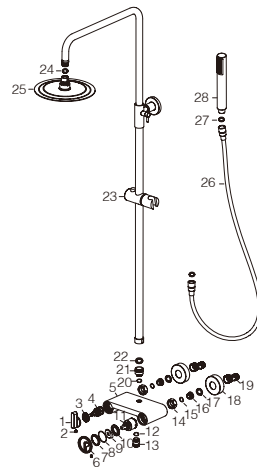

CODE	NAME	MATERIAL	REF	CODE	NAME	MATERIAL	REF
1	Handle	Zinc		20	O-ring	NBR	
2	Screw	SUS 304		21	Connect	Brass	
3	Nut	Brass		22	Rubber washer	NBR	
4	Cartridge	25mm up		23	Slider	SUS 304	RR0014*
5	Body	Brass		24	Rubber washer	NBR	
6	Handle	Zinc		25	Shower head	SUS 304	RDN001*
7	Decorative ring	ABS		26	Hose	SUS 304	FLX001*
8	O-ring	NBR		27	Rubber washer	NBR	
9	Decorative cup	Brass		28	Shower hand	ABS	MDR015*
10	Nut	Brass					
11	Cartridge	35mm up	CR1005*				
12	O-ring	NBR					
13	Connect	Brass					
14	Nut	Brass					
15	O-ring	NBR					
16	Valve	SUS 304					
17	Rubber washer	NBR					
18	Cover	SUS 304					
19	Cabrio leg	SUS 304					

* CONSULTAR PARA ACABADOS DE COLOR

Installing instruction

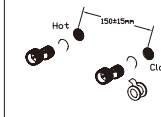

Step 1. Connect curved leg with the inlet pipe inside the wall

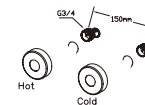

Step 2. Connect decorative cover to curved leg



Step 3. Install shower faucet properly and connect to curved leg on the wall

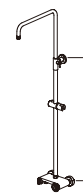

Step 4. Install shower pipe according to the distance of fix part

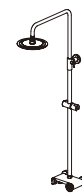

Step 5. Install shower hand and shower head to the set



Step 6. Test function of shower set, clean the set

Usage function instruction

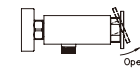
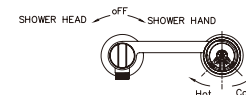

Open

FLOW RATE

Detalles	
FLOW RATE REF	BDC033
hand shower mixer water 0.1Mpa(L/MIN)	5.76
hand shower mixer water 0.3Mpa(L/MIN)	10.51
hand shower mixer water 0.5Mpa(L/MIN)	14.3
hand shower singer cold water 0.1Mpa(L/MIN)	5.77
hand shower singer cold water 0.3Mpa(L/MIN)	10.54
hand shower singer cold water 0.5Mpa(L/MIN)	14.4
shower head mixer water 0.1Mpa(L/MIN)	6.92
shower head mixer water 0.3Mpa(L/MIN)	12.36
shower head mixer water 0.5Mpa(L/MIN)	16.59
shower head singer cold water 0.1Mpa(L/MIN)	6.86
shower head singer cold water 0.3Mpa(L/MIN)	12.44
shower head singer cold water 0.5Mpa(L/MIN)	16.59

hand shower

shower head

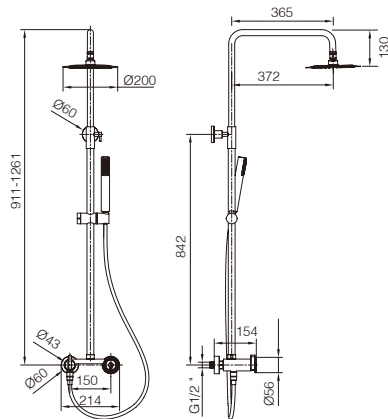
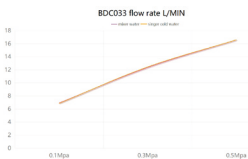
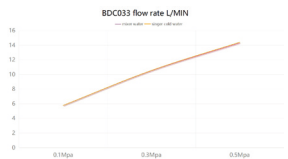

Product sizes (cm)	42.5*13.3*90
Weight (kg)	5.4
Guarantee	5 years
Max Preassure (bar)	5
Min Preassure (bar)	0.5
Optimum preassure (bar)	1-4 (Recommended 3)
Max. temperature	85°C
Min temperature	65°C

CERTIFIES

That all our products, provided that they are used in normal conditions or installed in accordance with current standards, are guaranteed against any manufacturing defect for a period of five years, except for products purchased before January 1, 2020, which will have the mand atory coverage of 2 years from the date of invoice.

Requirements and exclusions

Failure to comply with the instructions for assembly, use and maintenance of our products on the packaging and in our catalogue and published on our website: www.imexproducts.es, releases IMEX PRODUCTS, S.L. from any liability.

In any case, the acceptance of the defect by our technical department is necessary. In addition, transport costs will be charged only in the event that on IMEX PRODUCTS, S.L. technician determines the proper functioning of our products.

IMEX PRODUCTS, S.L. will decide to repair the product or replace it. It will be necessary to present the purchase invoice.

Assembly, maintenance or repairs carried out by non-specoalists re excluded from the warranty.

Wearing parts such as hoses, handles, seals, filters, aerators, etc. are not covered by the warranty.



**PRODUCT
INFORMATION
SUMMARY**

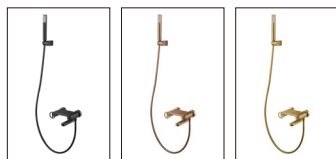

Ref.	EAN	Finish
BDC033-4	8435668010924	Chrome
BDC033-4NG	8435668010931	Matte black
BDC033-4ORC	8435668033831	Brushed rose gold
BDC033-4OC	8435668033824	Brushed gold

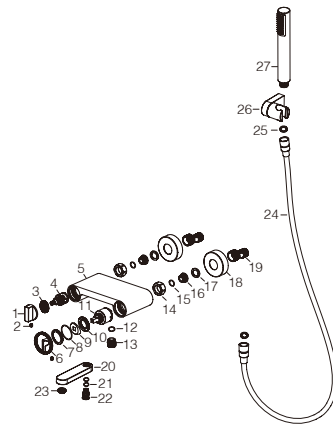

CODE	NAME	MATERIAL	REF	CODE	NAME	MATERIAL	REF
1	Handle	Zinc		20	Spout	Brass	
2	Screw	SUS 304		21	O-ring	NBR	
3	Nut	Brass		22	Connect	Brass	
4	Cartridge	25mm up		23	Aerator	M24x1mm	SAT-AIR019*
5	Body	Brass		24	Hose	SUS 304	FLX004*
6	Handle	Zinc		25	Rubber washer	NBR	
7	Decorative ring	ABS		26	Shower seat	ABS	SMD007*
8	O-ring	NBR		27	Shower hand	ABS	MDR015*
9	Decorative cup	Brass					
10	Nut	Brass					
11	Cartridge	35mm up	CRT005*				
12	O-ring	NBR					
13	Connect	Brass					
14	Nut	Brass					
15	O-ring	NBR					
16	Valve	SUS 304					
17	Rubber washer	NBR					
18	Cover	SUS 304					
19	Cabrio leg	SUS 304					

* CONSULTAR PARA ACABADOS DE COLOR

Installing instruction

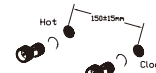

Step 1. Connect curved leg with the inlet pipe inside the wall

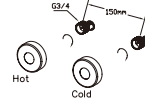

Step 2. Connect decorative cover to curved leg



Step 3. Install shower faucet properly, and connect to curved leg on the wall



Step 4. Test function of shower set, clean the set

Usage function instruction

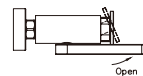
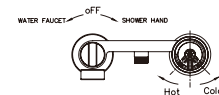

FLOW RATE

Detalles	
FLOW RATE REF	BDC033-4
water outlet mixer water 0.1Mpa(L/MIN)	4.77
water outlet mixer water 0.3Mpa(L/MIN)	8.21
water outlet mixer water 0.5Mpa(L/MIN)	10.56
water outlet singer cold water 0.1Mpa(L/MIN)	4.7
water outlet singer cold water 0.3Mpa(L/MIN)	8.19
water outlet singer cold water 0.5Mpa(L/MIN)	10.49
hand shower mixer water 0.1Mpa(L/MIN)	5.66
hand shower mixer water 0.3Mpa(L/MIN)	10.2
hand shower mixer water 0.5Mpa(L/MIN)	13.83
hand shower singer cold water 0.1Mpa(L/MIN)	5.59
hand shower singer cold water 0.3Mpa(L/MIN)	10.1
hand shower singer cold water 0.5Mpa(L/MIN)	13.7

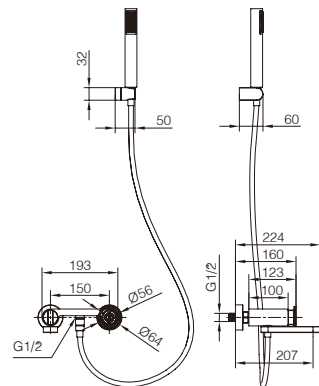

Product sizes (cm)	21.5*18*14
Weight (kg)	2.9
Guarantee	5 years
Max Preassure (bar)	5
Min Preassure (bar)	0.5
Optimum preassure (bar)	1-4 (Recommended 3)
Max. temperature	85°C
Min temperature	65°C

water outlet

hand shower

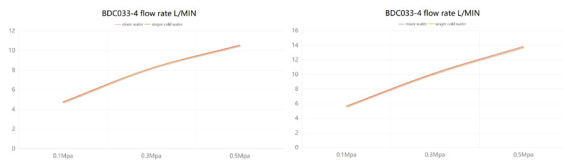

CERTIFIES

That all our products, provided that they are used in normal conditions or installed in accordance with current standards, are guaranteed against any manufacturing defect for a period of five years, except for products purchased before January 1, 2020, which will have the mandatory coverage of 2 years from the date of invoice.

Requirements and exclusions

Failure to comply with the instructions for assembly, use and maintenance of our products on the packaging and in our catalogue and published on our website: www.imexproducts.es, releases IMEX PRODUCTS, S.L. from any liability.

In any case, the acceptance of the defect by our technical department is necessary. In addition, transport costs will be charged only in the event that on IMEX PRODUCTS, S.L. technician determines the proper functioning of our products.

IMEX PRODUCTS, S.L. will decide to repair the product or replace it. It will be necessary to present the purchase invoice.

Assembly, maintenance or repairs carried out by non-specialists are excluded from the warranty.

Wearing parts such as hoses, handles, seals, filters, aerators, etc. are not covered by the warranty.



**PRODUCT
INFORMATION
SUMMARY**



Ref.	EAN	Finish
BDC033-5	8435668010955	Chrome
BDC033-SNG	8435668010962	Matte black
BDC033-SORC	8435668033855	Brushed rose gold
BDC033-SOC	8435668033848	Brushed gold

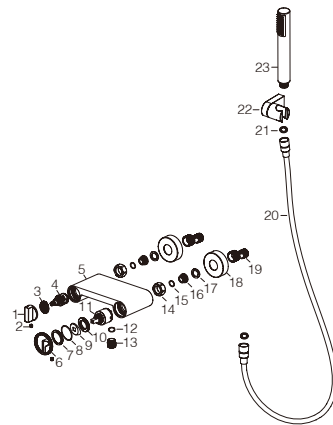

CODE	NAME	MATERIAL	REF	CODE	NAME	MATERIAL	REF
1	Handle	Zinc		20	Hose	SUS 304	FLX004*
2	Screw	SUS 304		21	Rubber washer	NBR	
3	Nut	Brass		22	Shower seat	ABS	SMD007*
4	Cartridge	25mm up		23	Shower hand	ABS	MDR015*
5	Body	Brass					
6	Handle	Zinc					
7	Decorative ring	ABS					
8	O-ring	NBR					
9	Decorative cap	Brass					
10	Nut	Brass					
11	Cartridge	35mm up	CRT005*				
12	O-ring	NBR					
13	Connect	Brass					
14	Nut	Brass					
15	O-ring	NBR					
16	Valve	SUS 304					
17	Rubber washer	NBR					
18	Cover	SUS 304					
19	Cabrio leg	SUS 304					

* CONSULTAR PARA ACABADOS DE COLOR

Installing instruction

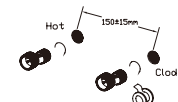

Step 1. Connect curved leg with the inlet pipe inside the wall

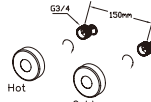

Step 2. Connect decorative cover to curved leg



Step 3. Install shower faucet properly, and connect to curved leg on the wall



Step 4. Test function of shower set, clean the set

Usage function instruction

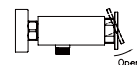
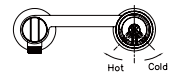

FLOW RATE

Detalles	
FLOW RATE REF	BDC033-5
mixer water 0.1Mpa(L/MIN)	5.7
mixer water 0.3Mpa(L/MIN)	10.65
mixer water 0.5Mpa(L/MIN)	14.38
singer cold water 0.1Mpa(L/MIN)	5.79
singer cold water 0.3Mpa(L/MIN)	10.57
singer cold water 0.5Mpa(L/MIN)	14.3

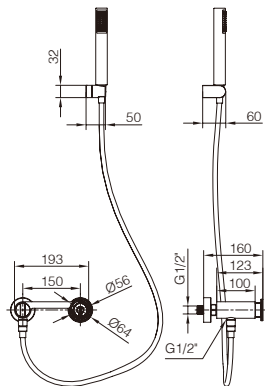
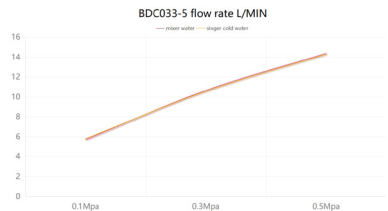

Product sizes (cm)	21.5*18*14
Weight (kg)	2.5
Guarantee	5 years
Max Preassure (bar)	5
Min Preassure (bar)	0.5
Optimum preassure (bar)	1-4 (Recommended 3)
Max. temperature	85°C
Min temperature	65°C

CERTIFIES

That all our products, provided that they are used in normal conditions or installed in accordance with current standards, are guaranteed against any manufacturing defect for a period of five years, except for products purchased before January 1, 2020, which will have the mand atory coverage of 2 years from the date of invoice.

Requirements and exclusions

Failure to comply with the instructions for assembly, use and maintenance of our products on the packaging and in our catalogue and published on our website: www.imexproducts.es, releases IMEX PRODUCTS, S.L. from any liability.

In any case, the acceptance of the defect by our technical department is necessary. In addition, transport costs will be charged only in the event that on IMEX PRODUCTS, S.L. technician determines the proper functioning of our products.

IMEX PRODUCTS, S.L. will decide to repair the product or replace it. It will be necessary to present the purchase invoice.

Assembly, maintenance or repairs carried out by non-specoalists re excluded from the warranty.

Wearing parts such as hoses, handles, seals, filters, aerators, etc. are not covered by the warranty.



PRODUCT INFORMATION SUMMARY

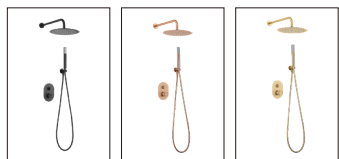

Ref.	EAN	Finish
GPC033	8435668011044	Chrome
GPC033/NG	8435668011051	Matte black
GPC033/ORC	8435668035408	Brushed rose gold
GPC033/OC	8435668035392	Brushed gold

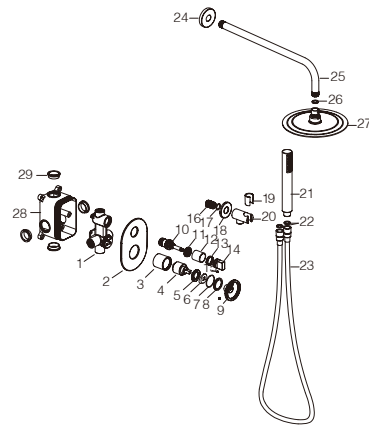

CODE	NAME	MATERIAL	REF	CODE	NAME	MATERIAL	REF
1	Body	Brass		20	Body	Brass	
2	Decorative plate	SUS 304		21	Shower hand	ABS	MDR015*
3	Cartridge cover	Brass		22	Rubber ring	NBR	
4	Cartridge	35mm	CRT006*	23	Hose	SUS 304	FLX001*
5	Nut	Brass		24	Cover	Brass	
6	Cartridge cup	Brass		25	Hose	SUS 304	
7	O-ring	NBR		26	Rubber ring	NBR	
8	Decorative ring	Brass		27	Shower head	SUS 304	RDN003*
9	Handle	Zinc		28	BOX	ABS	
10	Cartridge	Brass/27mm		29	Rubber ring	NBR	
11	Nut	Brass					
12	Cover	Brass					
13	Plastic washer	Plastic					
14	Handl	Zinc					
15	Screw	SUS 304					
16	Connect	Brass					
17	O-ring	NBR					
18	Cover	Brass					
19	Plastic washer	ABS					

* CONSULTAR PARA ACABADOS DE COLOR

Installing instruction

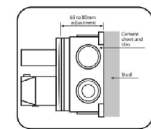

Step 1. Connect curved leg with the inlet pipe inside the wall

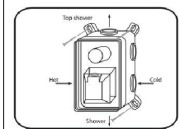

Step 2. Connect decorative cover to curved leg

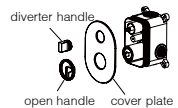

Step 3. Install shower faucet properly and connect to curved leg on the wall

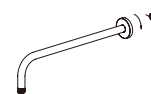

Step 4. Install shower pipe according to the distance of fix part



Step 5. Install shower hand and shower head to the set

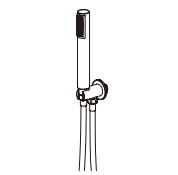

Step 6. Test function of shower set, clean the set

FLOW RATE

Detalles	
FLOW RATE REF	GPC033
hand shower mixer water 0.1Mpa(L/MIN)	5.85
hand shower mixer water 0.3Mpa(L/MIN)	10.74
hand shower mixer water 0.5Mpa(L/MIN)	14.43
hand shower singer cold water 0.1Mpa(L/MIN)	5.55
hand shower singer cold water 0.3Mpa(L/MIN)	10.05
hand shower singer cold water 0.5Mpa(L/MIN)	13.48
shower head mixer water 0.1Mpa(L/MIN)	5.87
shower head mixer water 0.3Mpa(L/MIN)	12.34
shower head mixer water 0.5Mpa(L/MIN)	15.75
shower head singer cold water 0.1Mpa(L/MIN)	6.1
shower head singer cold water 0.3Mpa(L/MIN)	11.58
shower head singer cold water 0.5Mpa(L/MIN)	15.37

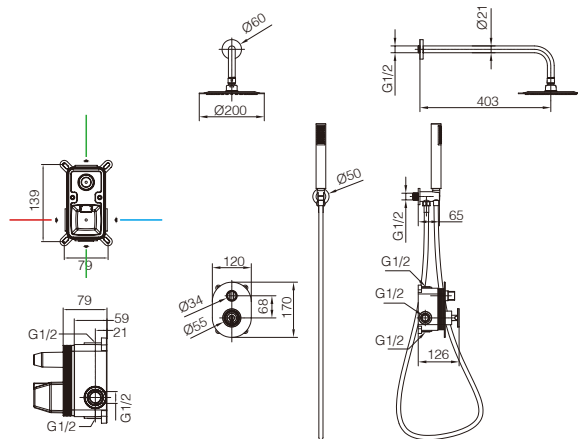

Product sizes (cm)	43*30*14
Weight (kg)	4.1
Guarantee	5 years
Max Preassure (bar)	5
Min Preassure (bar)	0.5
Optimum preassure (bar)	1-4 (Recommended 3)
Max. temperature	85°C
Min temperature	65°C

hand shower

shower head

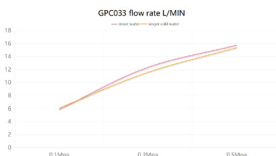
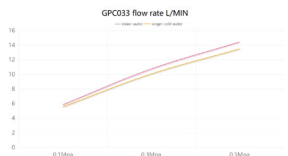

CERTIFIES

That all our products, provided that they are used in normal conditions or installed in accordance with current standards, are guaranteed against any manufacturing defect for a period of five years, except for products purchased before January 1, 2020, which will have the mand atory coverage of 2 years from the date of invoice.

Requirements and exclusions

Failure to comply with the instructions for assembly, use and maintenance of our products on the packaging and in our catalogue and published on our website: www.imexproducts.es, releases IMEX PRODUCTS, S.L. from any liability.

In any case, the acceptance of the defect by our technical department is necessary. In addition, transport costs will be charged only in the event that on IMEX PRODUCTS, S.L. technician determines the proper functioning of our products.

IMEX PRODUCTS, S.L. will decide to repair the product or replace it. It will be necessary to present the purchase invoice.

Assembly, maintenance or repairs carried out by non-specoalists re excluded from the warranty.

Wearing parts such as hoses, handles, seals, filters, aerators, etc. are not covered by the warranty.



PRODUCT INFORMATION SUMMARY

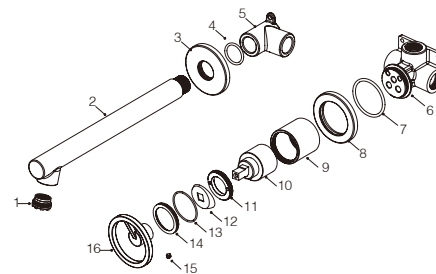

Ref.	EAN	Finish
GLC033	8435668010986	Chrome
GLC033/NG	8435668010993	Matte black
GLC033/ORC	8435668035163	Brushed rose gold
GLC033/OC	8435668035156	Brushed gold

CODE	NAME	MATERIAL	REF
1	Aerator	Aerator M18.5x1	SAT-AIR018*
2	Pipe	Brass	
3	Cover	Brass	
4	O-ring	NBR	
5	Connector	Brass	
6	Body	Brass	
7	O-ring	NBR	
8	Cover	Brass	
9	Cartridge cover	Brass	
10	Cartridge	35mm	CRT006*
11	Nut	Brass	
12	Decorative cup	Brass	
13	O-ring	NBR	
14	Decorative ring	Brass	
15	Screw	SUS 304	
16	Handle	Zinc	

Installing instruction

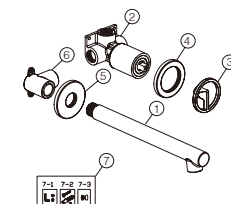

- Step 1. Check all spare parts
- 1- pipe
 - 2- body to handle
 - 3- handle
 - 4- cover plate of handle
 - 5- cover plate of pipe
 - 6- body to pipe
 - 7- spare part bag

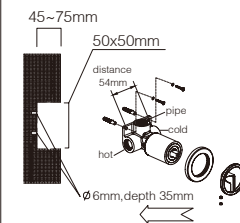

- Step 2. Dig hole for body to handle
- 2.1- Hole size 50*50mm, depth from 45 to 75mm
 - 2.2- Dig two 6mm holes with 54mm distance
 - 2.3- Assemble spare parts as picture shows

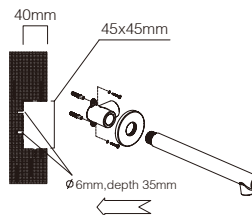

- Step 3. Dig hole for body to pipe
- 3.1- Hole size 45*45mm, depth 40mm
 - 3.2- Dig two 6mm holes with 35mm distance
 - 3.3- Assemble spare parts as picture shows

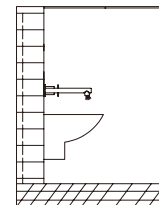

- Step 4. Connect inside pipe and test for leak checking

FLOW RATE

Detalles	
FLOW RATE REF	GLC033
mixer water 0.1Mpa(L/MIN)	4.51
mixer water 0.3Mpa(L/MIN)	7.67
mixer water 0.5Mpa(L/MIN)	9.89
singer cold water 0.1Mpa(L/MIN)	4.86
singer cold water 0.3Mpa(L/MIN)	8.27
singer cold water 0.5Mpa(L/MIN)	10.6

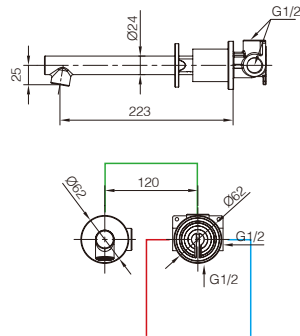
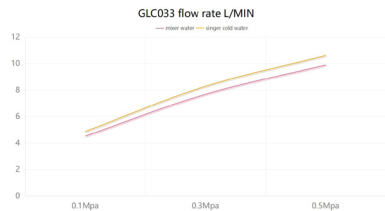

Product sizes (cm)	29*17.5*6.7
Weight (kg)	1
Guarantee	5 years
Max Preassure (bar)	5
Min Preassure (bar)	0.5
Optimum preassure (bar)	1-4 (Recommended 3)
Max. temperature	85°C
Min temperature	65°C

CERTIFIES

That all our products, provided that they are used in normal conditions or installed in accordance with current standards, are guaranteed against any manufacturing defect for a period of five years, except for products purchased before January 1, 2020, which will have the mand atory coverage of 2 years from the date of invoice.

Requirements and exclusions

Failure to comply with the instructions for assembly, use and maintenance of our products on the packaging and in our catalogue and published on our website: www.imexproducts.es, releases IMEX PRODUCTS, S.L. from any liability.

In any case, the acceptance of the defect by our technical department is necessary. In addition, transport costs will be charged only in the event that on IMEX PRODUCTS, S.L. technician determines the proper functioning of our products.

IMEX PRODUCTS, S.L. will decide to repair the product or replace it. It will be necessary to present the purchase invoice.

Assembly, maintenance or repairs carried out by non-specoalists re excluded from the warranty.

Wearing parts such as hoses, handles, seals, filters, aerators, etc. are not covered by the warranty.

