

1. rubber gasket
2. plastic gasket
3. fix nut
4. faucet body
5. cartridge handle&base
6. inlet hose

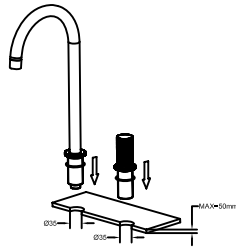

1. Before installation, make sure that there are two through holes on the table, remove the fixing components at the bottom of the faucet body, and then put the faucet body into the table face. The bottom of the main body must be padded with the base sealing ring.

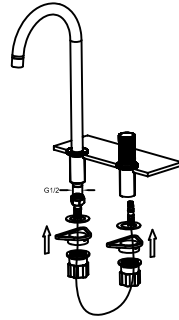

2. Thread the connecting hose through the mounting assembly and connect it. Fix the faucet body with the mounting assembly.

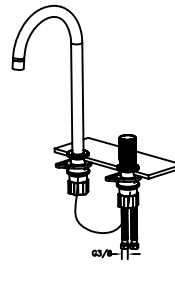

3. Install the red and blue water inlet hose.

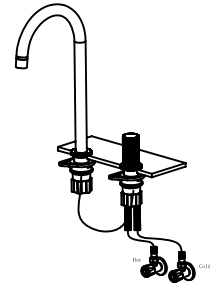

4. Install the red and blue water inlet hose to the angle valve.

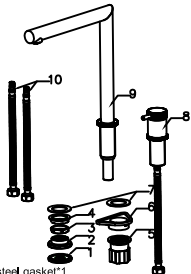

1. steel gasket\*1
2. rotating fixing nut assembly\*1
3. hex nuts\*1
4. fix nut\*1
5. plastic fix nut\*1
6. plastic tri-angle gasket\*1
7. flat gasket\*2
8. cartridge base&handle\*1
9. faucet body\*1
10. inlet hose\*2

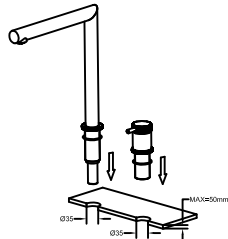

1. Before installation, make sure that there are two through holes on the table, remove the fixing components at the bottom of the faucet body, and then put the faucet body into the table face. The bottom of the main body must be padded with the base sealing ring.

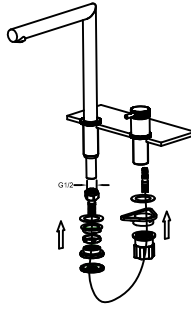

2. Thread the connecting hose through the mounting assembly and connect it. Fix the faucet body with the mounting assembly.

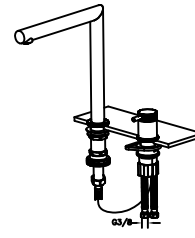

3. Install the red and blue water inlet hose.

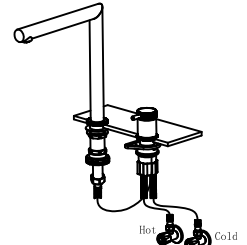

4. Install the red and blue water inlet hose to the angle valve.